

TINI Q-G® CONNECTORS

PRODUCT BULLETIN 550

TRASM*M, TRAPC*M Series

Switchcraft introduces an expansion of its popular TQG Series of connectors. The TRASM*M and TRAPC*M offers low profile, right angle PC board mount connectors. The TRASM*M versions are true surface mount connectors, while the TRAPC*M versions are through-hole PC mount connectors. Both versions are available in 3-8 pins. All plastic connectors, the TRASM*M and TRAPC*M series have flats on the top of the connectors to facilitate pick and place assembly. As an added option, a non-threaded bushing version is also available. See the Engineering Design Guide or our website for the complete line of Tini QG® connectors.

Features and Benefits

- Low profile, compact design reduces PC board space
- Mates with TQG female cord plugs
- Rated at 5A for 3-6 pins, 3A for 7 and 8 pin versions

Markets

- Wireless microphone systems
- Medical Instrumentation
- Test Instrumentation

Specifications

Materials:

Housing: Thermoplastic
Contacts: Brass, tin-plated
Nut and Washer: Brass, nickel-plated

Electrical

Current Rating: 5A for 3-6 pins, 3A for 7 and 8
Contact Resistance: 10 m Ohm max
Insulation Resistance: 100 m Ohm min
Dielectric Withstanding Voltage: 250VAC

Mechanical Life: 2,000 cycles

Ordering information

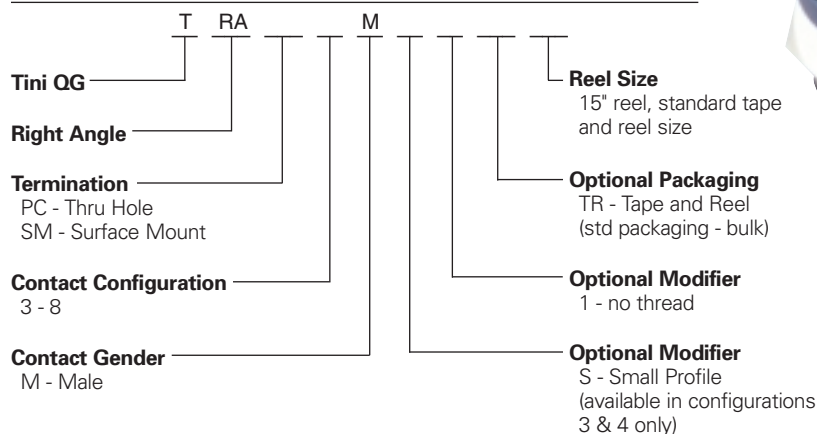

TRASM3M



TRAPC3MS

Switchcraft®

www.switchcraft.com

TRASM*M, TRAPC*M Series

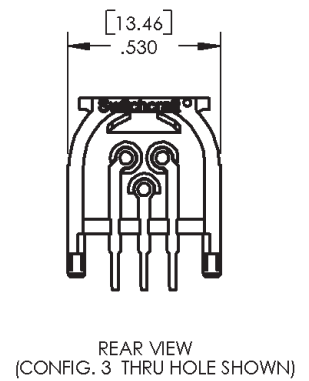
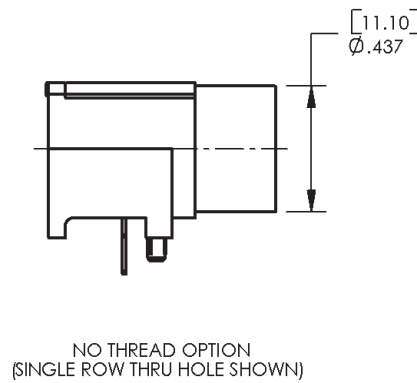
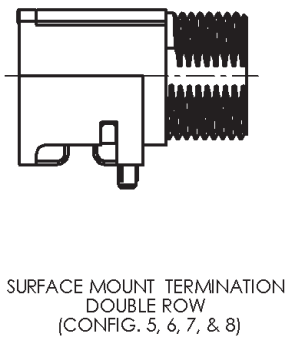
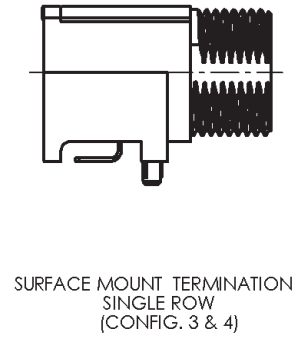
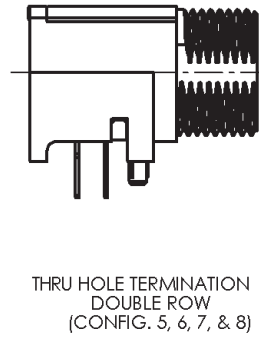
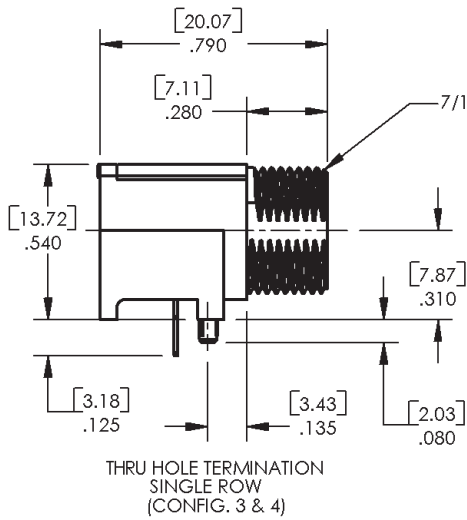

Notes:

1. Threaded connectors supplied with hex nut and washer
2. Dimensions are in [mm]
inch

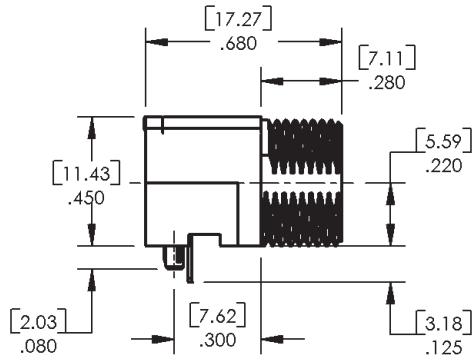

SMALL PROFILE
THRU HOLE TERMINATION

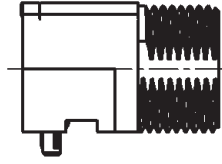

SMALL PROFILE
SURFACE MOUNT TERMINATION

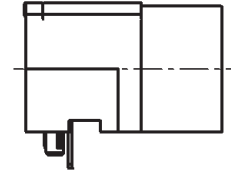

SMALL PROFILE
NO THREAD OPTION
(THRU HOLE SHOWN)

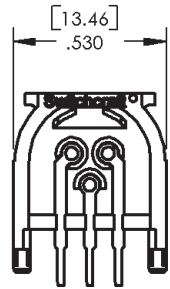

REAR VIEW
(CONFIG. 3 THRU HOLE SHOWN)

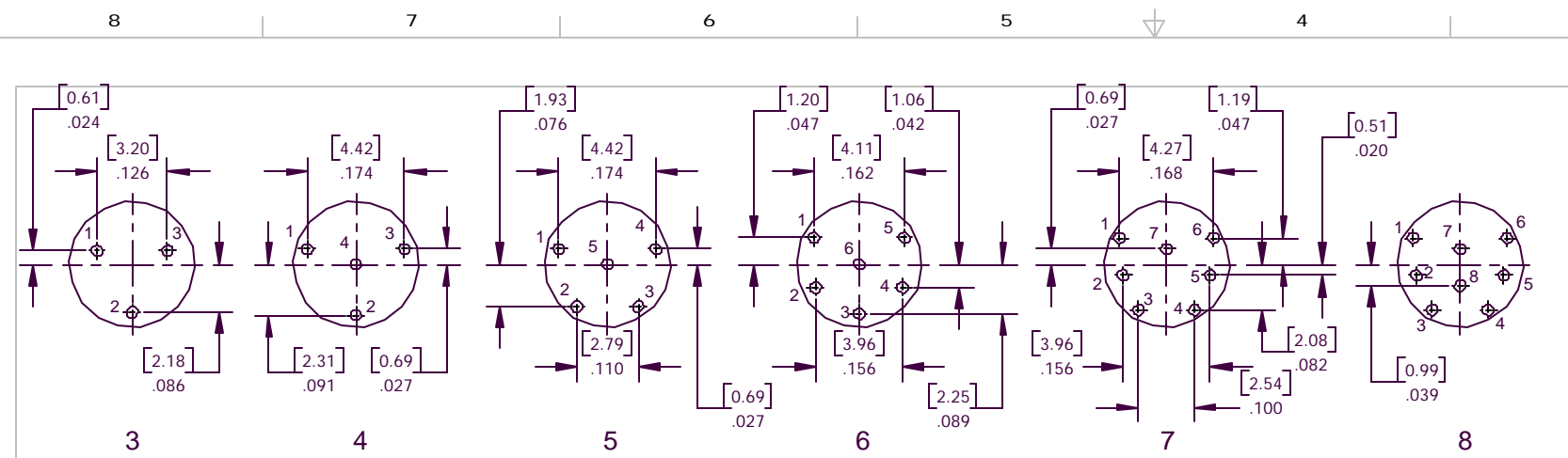

CONTACT CONFIGURATIONS (FRONT VIEW)

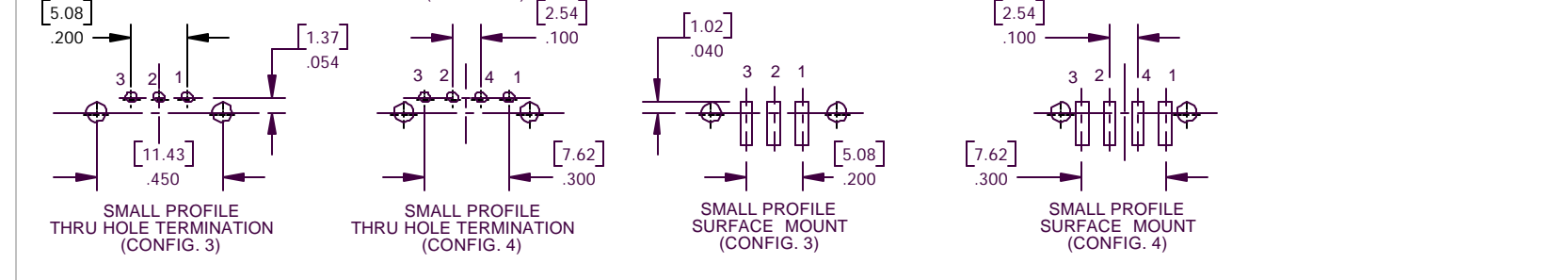
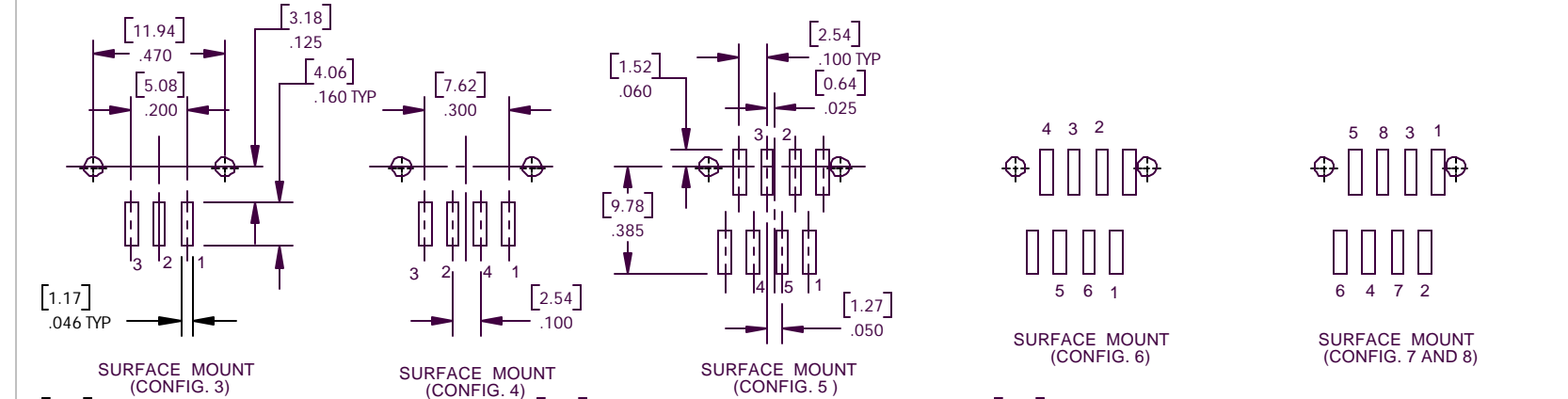
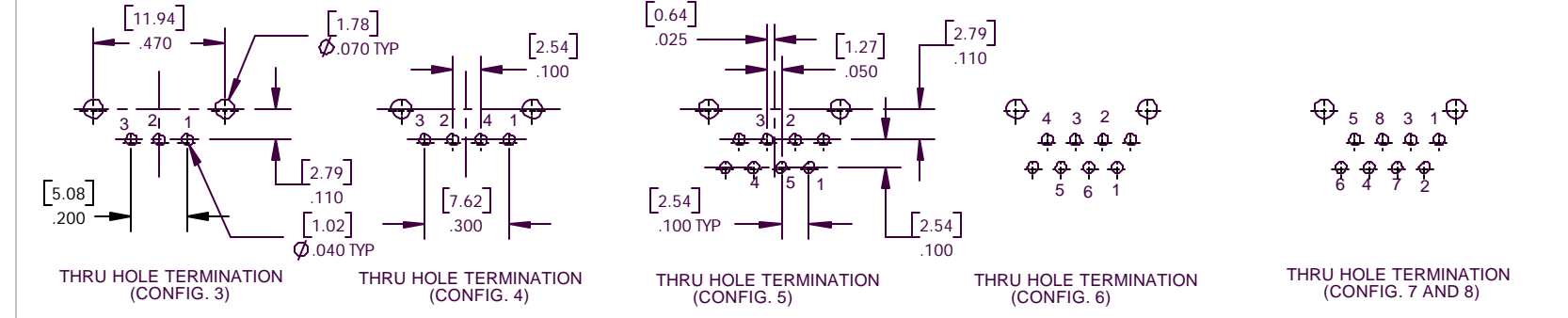

RECOMMENDED PC BOARD LAYOUTS

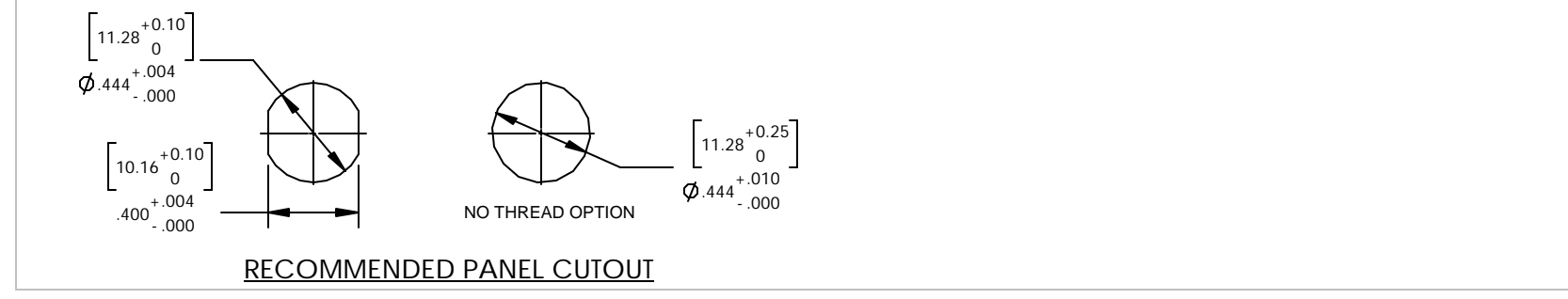

- NOTES:**
- THIS IS A DRAWING FOR A NEW PRODUCT BULLETIN. IT WILL BE REDUCED APPROXIMATELY 50% FOR REPRODUCTION.
 - THE SMALLER BORDER IS FOR NO REDUCTION i.e. 1:1 SCALE (SMALL ASSEMBLIES). DELETE THIS BORDER IF YOU ARE USING A 50% REDUCTION (LARGE ASSEMBLIES).
 - ALL OF THE VIEWS AND NOTES MUST FIT INSIDE THE OUTLINED AREA.
 - TEXT HEIGHT:
 - ALL DIMENSIONS AND NOTES SHOULD BE 0.125 HIGH TEXT.
 - HEADINGS SHOULD BE 0.187 HIGH TEXT.
 - FOR SPECIAL DESIGNATIONS THE HEIGHT SHOULD BE NO SMALLER THAN 0.010.
 - PUT ALL DIMENSIONS ON A LAYER CALLED "DIMS".
 - PUT ALL NOTES ON A LAYER CALLED "NOTES".

APPROVED BY:

NPB547

SCALE 2.5:1	Switchcraft [®]	
DATE DRAWN 11-10-00		
DRAWN BY MA	PART No. TRASM5M-2	REV 0C