

LP SERIES  
**LOW PROFILE**  
DC POWER JACKS



**Switchcraft**<sup>®</sup>  
**CONXALL**<sup>®</sup>

HARSH ENVIRONMENT CONNECTIVITY SOLUTIONS

5555 N ELSTON AVE | CHICAGO, IL | 773.792.2700 | SALES@SWITCHCRAFT.COM | WWW.SWITCHCRAFT.COM

## PCB - SIDE VIEW

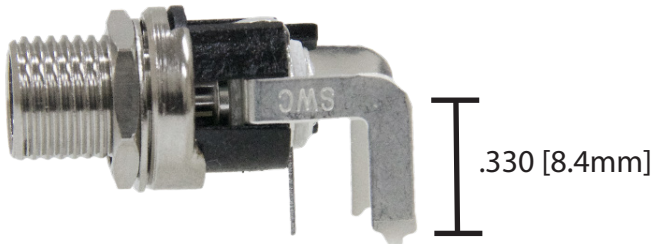

**STANDARD**

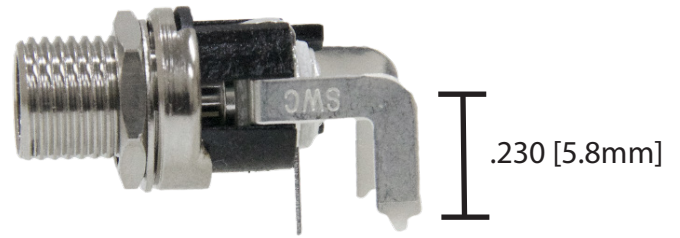

**LOW PROFILE**

### NEW! LP SERIES

**SWITCHCRAFT DC POWER JACKS WITH 30% LOWER HEIGHT** DC Power Jacks from Switchcraft are made in USA and for decades have been the most trusted jacks for critical devices all over the world. This new series is especially designed for today's compact electronic devices, reducing the distance from the PCB to the center of the jack from 0.330" to 0.230". Only the height dimensions have changed, they still mate with standard plugs from Switchcraft or other manufacturers and the overall design remains the same. They are available with a full range of center pin diameters and bushing lengths with standard and high temperature options.



**LOW PROFILE DESIGN**

Minimizing the height of the jacks makes it easier to fit in compact electronic devices



**10,000 CYCLES**

Rated for a minimum of 10,000 insertion/withdrawal cycles



**MADE IN USA**

Made in the Switchcraft factory in Chicago using high quality materials

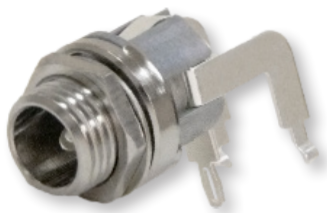

**721RAHLP**



**722RAHLP**



**L721RAHLP**

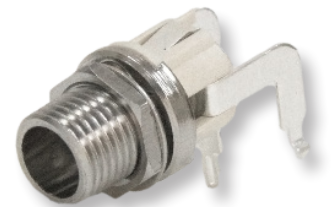

**L722RAHLP**

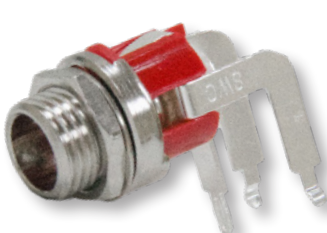

**721RALP**



**722RALP**

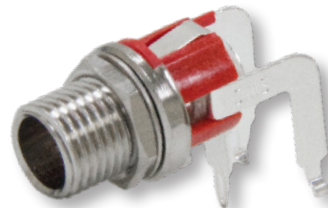

**L721RALP**



**L722RALP**

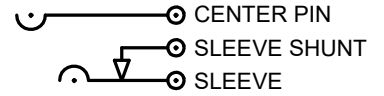
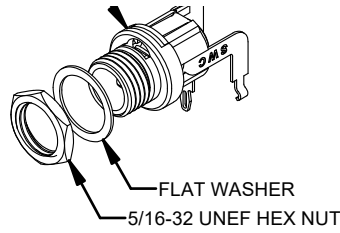
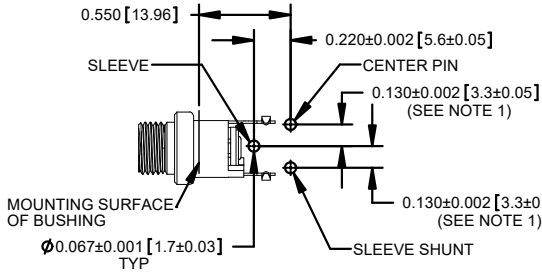

## Recommended PCB Layout (Component Side)

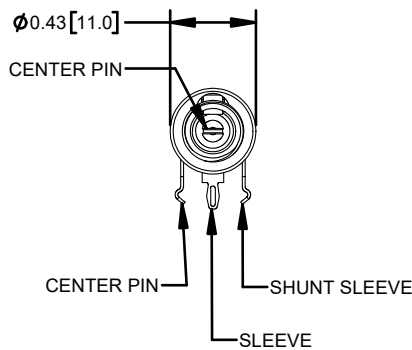

## Included Hardware

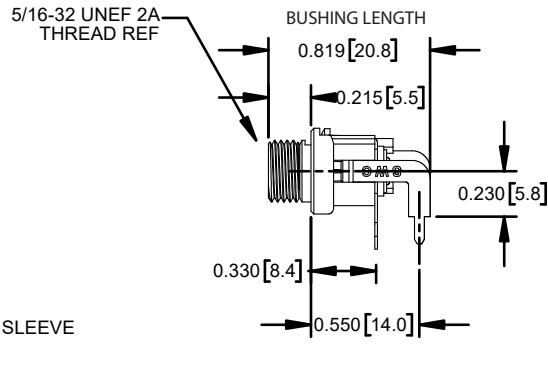

## Schematic

## Dimensions

| PART NO.  | PIN DIAMETER | BUSHING LENGTH | TEMP. MAX (°C) | CURRENT RATING | MATING PLUG                  |
|-----------|--------------|----------------|----------------|----------------|------------------------------|
| 712RAHLP  | 2.5mm        | 5.5mm          | 105°C          | 7.5A           | 760H, 765H, 760KH, 765KH     |
| 712RALP   | 2.5mm        | 5.5mm          | 85°C           | 5.0A           | 760, 765, 760K, 765K         |
| 721RAHLP  | 2.1mm        | 5.5mm          | 105°C          | 7.5A           | 762H, 762KH, 767H, 767KH     |
| 721RALP   | 2.1mm        | 5.5mm          | 85°C           | 5.0A           | 762, 762K, 767, 767K         |
| 722RAHLP  | 2.0mm        | 5.5mm          | 105°C          | 7.5A           | S760H, S765H, S760KH, S765KH |
| 722RALP   | 2.0mm        | 5.5mm          | 85°C           | 5.0A           | S760, S765, S760K, S765K     |
| 732RAHLP  | 1.3mm        | 5.5mm          | 105°C          | 7.5A           | N/A                          |
| 732RALP   | 1.3mm        | 5.5mm          | 85°C           | 5.0A           | N/A                          |
| L712RAHLP | 2.5mm        | 8.1mm          | 105°C          | 7.5A           | 761KH, 766KH                 |
| L712RALP  | 2.5mm        | 8.1mm          | 85°C           | 5.0A           | 761K, 766K                   |
| L721RAHLP | 2.1mm        | 8.1mm          | 105°C          | 7.5A           | 763KH, 768KH                 |
| L721RALP  | 2.1mm        | 8.1mm          | 85°C           | 5.0A           | 763K, 768K                   |
| L722RAHLP | 2.0mm        | 8.1mm          | 105°C          | 7.5A           | S761KH, S766KH               |
| L722RALP  | 2.0mm        | 8.1mm          | 85°C           | 5.0A           | S761K, S766K                 |
| L732RAHLP | 1.3mm        | 8.1mm          | 105°C          | 7.5A           | N/A                          |
| L732RALP  | 1.3mm        | 8.1mm          | 85°C           | 5.0A           | N/A                          |

## SPECIFICATIONS

### MECHANICAL:

Life: 10,000 insertion/withdrawal cycles minimum  
 Insertion/Withdrawal Forces: 3 pound max. insertion, 4 ounce min. withdrawal

### ELECTRICAL:

Contact Resistance .01 ohms maximum  
 (initial) .02 ohms maximum (after humidity, durability exposure), .1 ohms maximum (after salt)  
 Insulation Resistance: 10,000 MΩ minimum (initial), 1,000 MΩ minimum (after humidity, durability exposure)  
 Dielectric Voltage 500V AC maximum  
 Contact Rating (Std.): 5A, 12V DC resistive.  
 (High Temp): 7.5A, 12V DC resistive

### ENVIRONMENTAL:

Thermal Range (Std.): -55°C to + 85°C.  
 (High Temp): -40°C to 105°C  
 Humidity: Meets MIL-STD-202, method 106D.  
 Thermal Shock: Meets MIL-STD-202, method 107D  
 Salt Spray Meets MIL-STD-202, method 101

### MATERIAL:

Housing: Molded plastic (High Temp = High PBT)  
 Mounting Bushing Plated copper alloy  
 Hex Nut: Plated copper alloy  
 Pin: Plated copper alloy  
 Spring: Plated copper alloy  
 Terminals: Plated copper alloy  
 Insulators: Rigid plastic  
 Hardware: Supplied with one Number P2439 nickel-plated brass hex nut, and one Number P2441 nickel plated steel flat washer