

NOTES:

1. ALL PARTS TO BE BULK PACKED.
2. CONTACTS ARE SHIPPED LOOSE
3. ALL DIMENSIONS ARE REFERENCE EXCEPT THOSE WITH A TOLERANCE

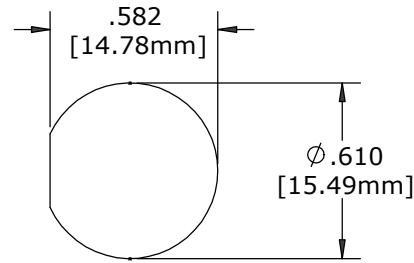

**RECOMMENDED
PANEL CUT-OUT**
TOLERANCE: ±.003

ASSY P/N	CONTACT QTY.	"X" DIM.	"Y" DIM
W7280-2PG-300	2 #20	0.653 [16.6mm]	.138 [3.5mm]
W7280-3PG-300	3 #20	0.670 [17.0mm]	.142 [3.6mm]
W7280-4PG-300	4 #20	0.670 [17.0mm]	.142 [3.6mm]
W7280-5PG-300	5 #20	0.670 [17.0mm]	.142 [3.6mm]
W7280-6PG-300	6 #20	0.670 [17.0mm]	.142 [3.6mm]
W7280-7PG-300	7 #20	0.673 [17.1mm]	.142 [3.6mm]
W7280-8PG-300	8 #20	0.673 [17.1mm]	.142 [3.6mm]

Ⓟ

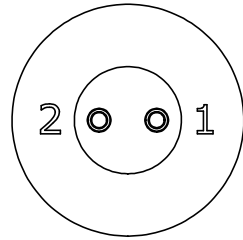

WIRING END
ASSY: W7280-2PG-300

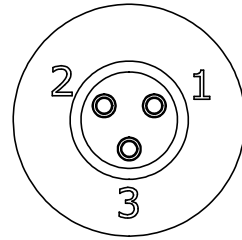

WIRING END
ASSY: W7280-3PG-300

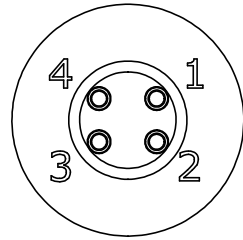

WIRING END
ASSY: W7280-4PG-300

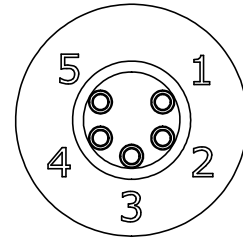

WIRING END
ASSY: W7280-5PG-300

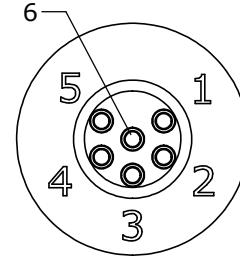

WIRING END
ASSY: W7280-6PG-300

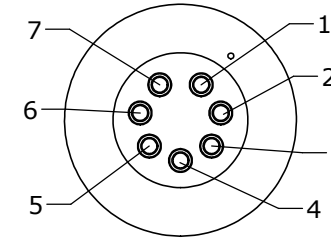

WIRING END
ASSY: W7280-7PG-300

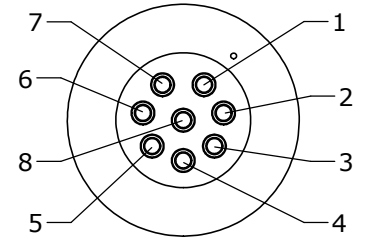

WIRING END
ASSY: W7280-8PG-300

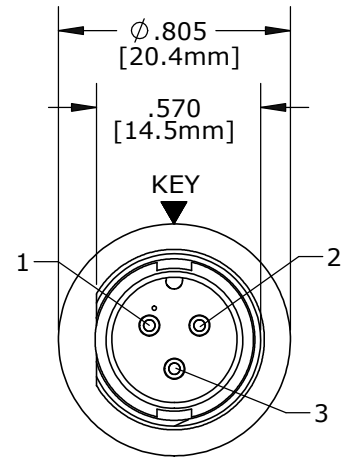

MATING FACE
ASSY: W7280-3PG-300 SHOWN

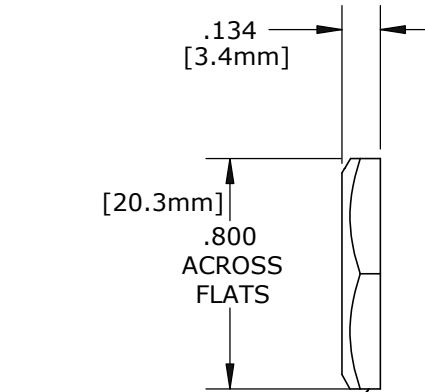

HEX NUT
MAT'L: UV PBT, BLACK

Ⓟ

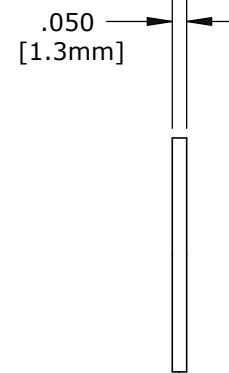

GASKET
MAT'L: RUBBER, BLACK

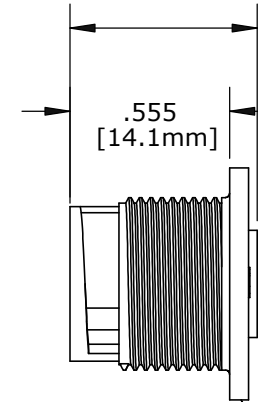

"X" DIM.
SEE CHART

PANEL CONNECTOR, MALE
MAT'L: UV PBT, BLACK

Ⓟ

(2-8)-#20 PIN CONTACTS
CRIMP TAIL
MAT'L: GOLD PLATED
COPPER ALLOY

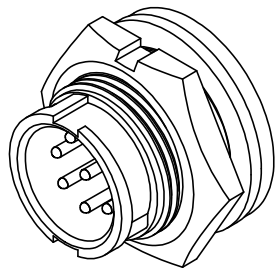

SHOWN ASSEMBLED KIT
FOR CUSTOMER REFERENCE ONLY

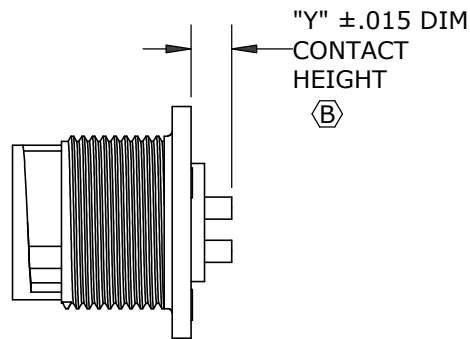

"Y" ±.015 DIM
CONTACT
HEIGHT
Ⓟ

DIMENSIONS IN BRACKETS [] ARE IN MILLIMETERS

CUSTOMER APPROVAL

THIS DOCUMENT CONTAINS CONFIDENTIAL INFORMATION PROPRIETARY TO CONXALL CORPORATION. ANY REPRODUCTION, DISCLOSURE, OR USE OF THIS DOCUMENT /INFORMATION IS EXPRESSLY PROHIBITED UNLESS AUTHORIZED IN WRITING BY CONXALL CORPORATION.

APPROVED BY: _____
DATE: _____

B	MA	01-06-22	MAT'L COLOR WAS CHARCOAL BLACK PER ECR 9584-2. ADDED CONTACT HEIGHT DIM "Y"
A	AN	06-20-18	DRAWING CREATED PER DOR 16-E256SL #3
REV.	INIT.	DATE	DESCRIPTION
	AN	04-30-18	ORIG. DRAWN BY: DATE: 04-30-18
			CHECKED BY:
			APPROVED BY:
SCALE	SIZE	SHEET	TITLE: PANEL MOUNT ASSEMBLY, UV (2-8) #20 PIN CONTACTS MINI-CON-X
NTS	B	1 OF 1	
FILE:	DIRECTORY:	PART NUMBER:	CUSTOMER: STANDARD PRODUCT
W7280-XPG-300	SLW	W7280-XPG-300	REV B

RoHS COMPLIANT

⚠ - CRITICAL CHARACTERISTIC FLAG PER SPEC. XXXX