

ASS'Y P/N	NO. OF CONTACTS
W17292-2PG-P-3ES	2
W17292-3PG-P-3ES	3

NOTES:

- PANEL CONNECTORS TO BE PACKED IN PARTITION BOX, 200 PC PER BOX
HEX NUT AND GASKET TO BE BULK PACKED IN A SEPARATE BAG
FROM PANEL ASSEMBLY PACKAGE.
a) INNER BOX LABELED WITH CXA PART NUMBER, QUANTITY, LOT #
AND DATE CODE AS SHOWN
- CONTACTS ARE INSERTED INTO PANEL CONNECTOR.
- BACK END OF CONNECTOR FILLED WITH EPOXY
- SEE DRAWING HPMCSTD FOR HOLE PATTERN
- ALL DIMENSIONS ARE FOR REFERENCE ONLY UNLESS OTHERWISE SPECIFIED.

P/N: W17292-XPG-P-3ES
CONXALL
QTY:
Lot:
Date Code:

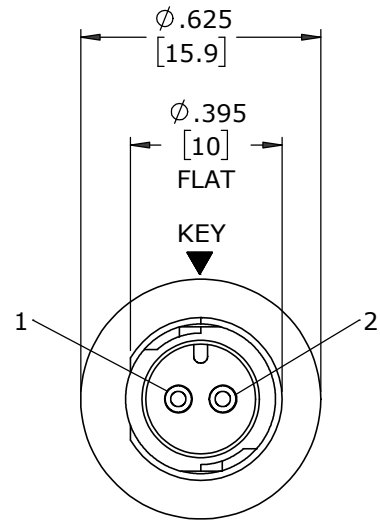

FACE VIEW
W17292-2PG-P-3ES
MAT'L: UV PBT, BLACK

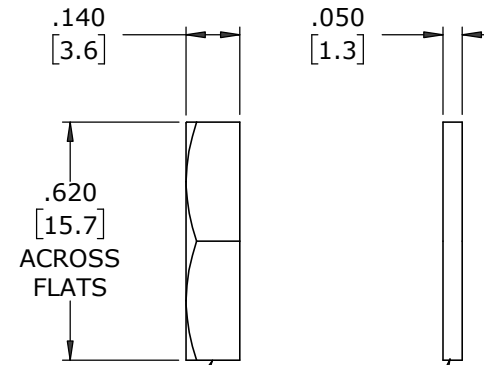

HEX NUT
MAT'L: NEOPRENE, BLACK
GASKET

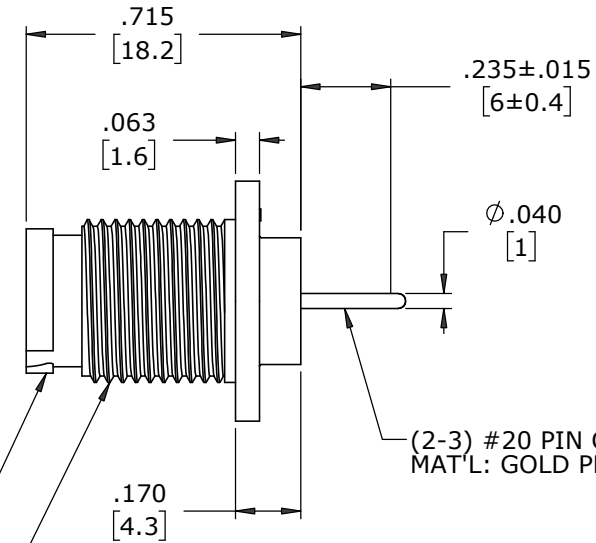

(2-3) #20 PIN CONTACTS
MAT'L: GOLD PLATED COPPER ALLOY

PANEL CONNECTOR, MALE
MAT'L: UV PBT, BLACK

7/16-28UNEF-2A
MODIFIED THREAD

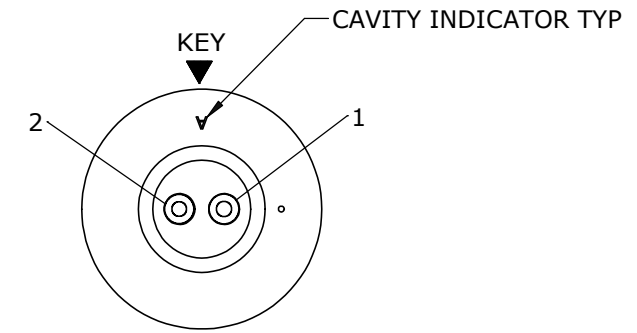

WIRE VIEW
W17292-2PG-P-3ES

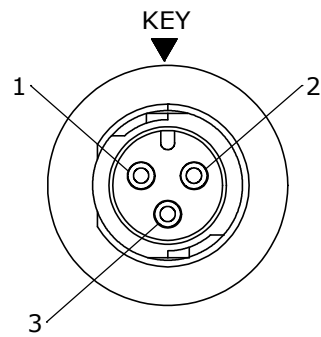

FACE VIEW
W17292-3PG-P-3ES

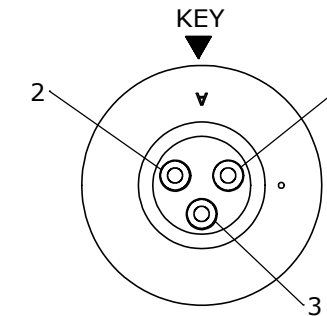

WIRE VIEW
W17292-3PG-P-3ES

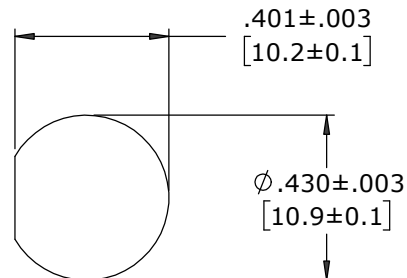

**RECOMMENDED
PANEL CUT-OUT**

DIMENSIONS IN BRACKETS [] ARE IN MILLIMETERS UNLESS INDICATED

CUSTOMER APPROVAL

THIS DOCUMENT CONTAINS CONFIDENTIAL INFORMATION PROPRIETARY TO CONXALL CORPORATION. ANY REPRODUCTION, DISCLOSURE, OR USE OF THIS DOCUMENT /INFORMATION IS EXPRESSLY PROHIBITED UNLESS AUTHORIZED IN WRITING BY CONXALL CORPORATION.

APPROVED BY: _____
DATE: _____

RoHS COMPLIANT

A	MA	08-05-20	DRAWING CREATED PER PDR 18004-2	
REV.	INIT.	DATE	DESCRIPTION	
	MA	08-05-20	ALL INFORMATION ILLUSTRATED IS THE PROPERTY OF "CONXALL CORPORATION". UNAUTHORIZED DUPLICATION OR DISTRIBUTION OF THIS DOCUMENT IS PROHIBITED.	
APPROVED BY:			TITLE: PANEL MOUNT ASSEMBLY (2-3) #20 PIN CONTACTS, XL PC TAIL INSTA-CLICK™ MICRO-CON-X STANDARD PRODUCT	
SCALE	SIZE	SHEET	CUSTOMER:	
NTS	B	1 OF 1	PART NUMBER: W17292-XPG-P-3ES	
FILE:	DIRECTORY:	PART	REV	
W17292-XPG-P-3ES	SLW	NUMBER:	A	



601 E. WILDWOOD VILLA PARK, IL 60181

CUSTOMER PRINT

PART NUMBER: W17292-XPG-P-3ES