

NOTES:

1. FINISHED PRODUCT TO BE BOXED.  
HEX NUTS AND GASKETS MAY BE PACKAGED SEPARATELY.  
2. CONTACTS ASSEMBLED INTO CONNECTOR  
3. REAR WELL OF CONNECTOR FILLED WITH EPOXY  
4. ALL DIMENSIONS ARE REFERENCE EXCEPT THOSE WITH A TOLERANCE  
5. SEE DRAWING HPMUSTD FOR HOLE PATTERN

ASSY P/N	NO. OF PIN
4181-2PG-3ES	2
4181-3PG-3ES	3
4181-4PG-3ES	4

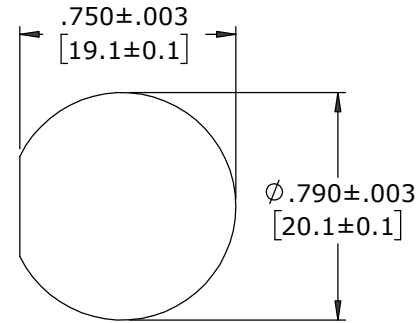

RECOMMENDED  
PANEL CUT OUT

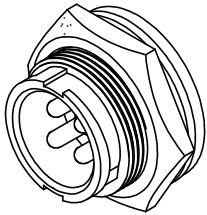

SHOWN ASSEMBLED KIT  
FOR CUSTOMER REFERENCE ONLY

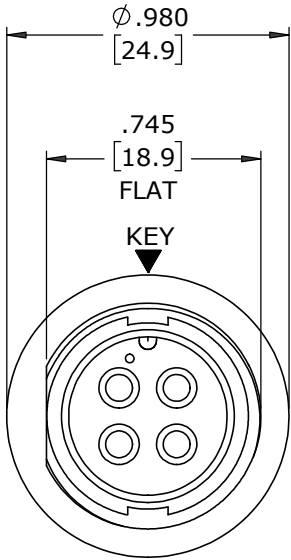

FACE VIEW  
4181-4PG-3ES SHOWN

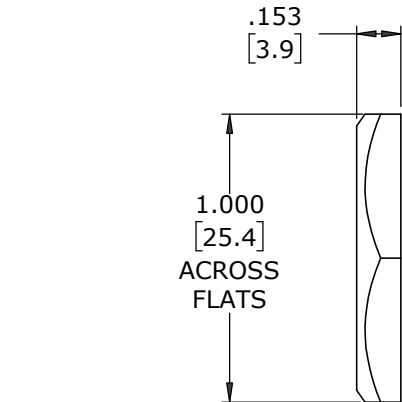

HEX NUT  
MAT'L: NYLON, BLACK

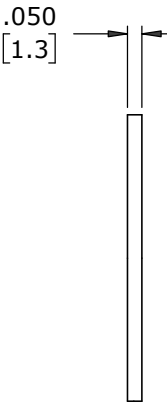

GASKET  
MAT'L: RUBBER, BLACK

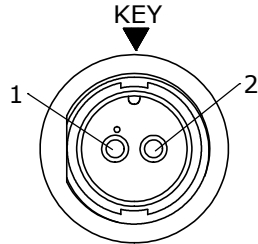
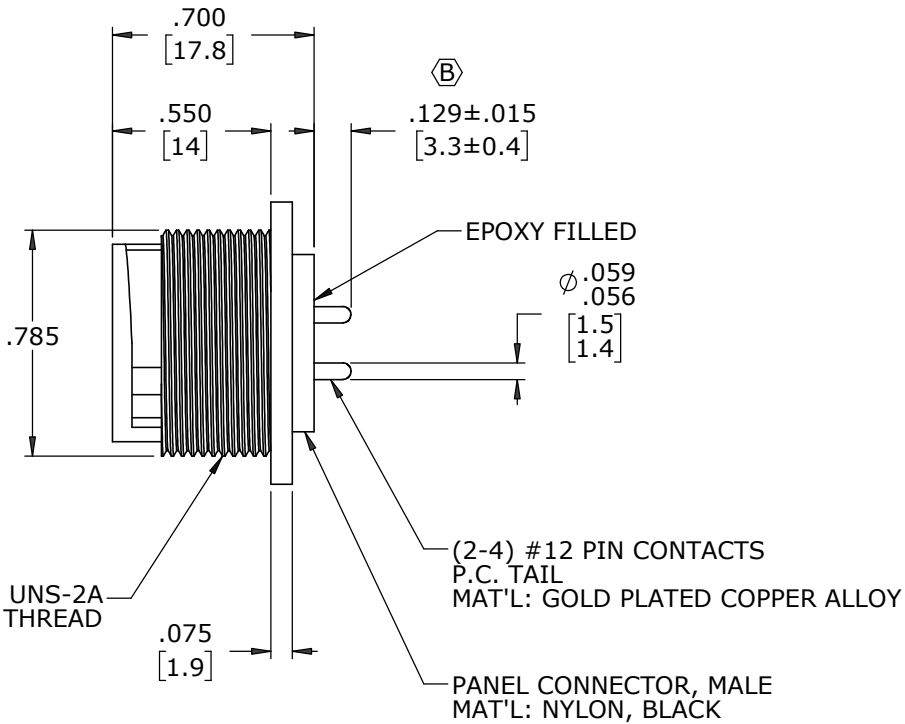

FACE VIEW  
4181-4PG-3ES

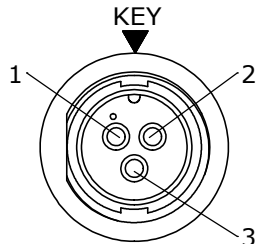

FACE VIEW  
4181-4PG-3ES

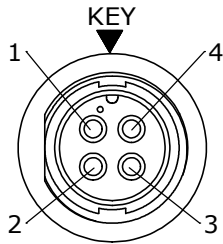

FACE VIEW  
4181-4PG-3ES

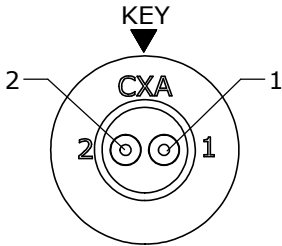

WIRE VIEW  
4181-2PG-3ES

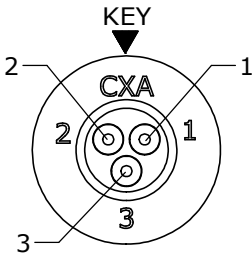

WIRE VIEW  
4181-3PG-3ES

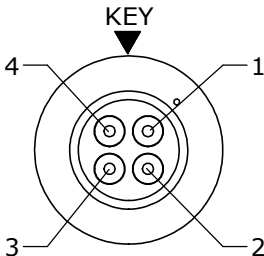

WIRE VIEW  
4181-4PG-3ES

DIMENSIONS IN BRACKETS [ ] ARE IN MILLIMETERS

CUSTOMER APPROVAL	
THIS DOCUMENT CONTAINS CONFIDENTIAL INFORMATION PROPRIETARY TO CONXALL CORPORATION. ANY REPRODUCTION, DISCLOSURE, OR USE OF THIS DOCUMENT /INFORMATION IS EXPRESSLY PROHIBITED UNLESS AUTHORIZED IN WRITING BY CONXALL CORPORATION.	
APPROVED BY:	_____
DATE:	_____

RoHS COMPLIANT

B	MA	12-11-20	CONTACT HEIGHT WAS .220, REMOVED TOLERANCES FROM PIECE PARTS PER ECR 9218-2. PACKAGING NOTE 1 WAS BULK PACK PER ECR 9553						
A	AN	08-20-12	DRAWING CREATED PER DOR 12-E149SL #23						
REV.	INIT.	DATE	DESCRIPTION						
<div>ALL INFORMATION ILLUSTRATED IS THE PROPERTY OF "CONXALL CORPORATION". UNAUTHORIZED DUPLICATION OR DISTRIBUTION OF THIS DOCUMENT IS PROHIBITED.</div>			ORIG. DRAWN BY: <b>AN</b>		DATE: <b>08-20-12</b>		<div>conxall</div> <div>601 E. WILDWOOD VILLA PARK, IL 60181</div>		
			CHECKED BY:						
<div>ALL UNITS ARE IN FEET, INCHES, FRACTION OF INCHES AND DECIMALS.</div> <div>UNLESS OTHERWISE SPECIFIED TOLERANCES: 3 PLACE DECIMALS ±.010 ANGLES ±1° FRACTIONS ±1/16</div>			APPROVED BY:		TITLE: <b>PANEL MOUNT ASSEMBLY (2-4) #12 PIN CONTACTS, PC TAIL MULTI-CON-X</b>				
					CUSTOMER: <b>STANDARD PRODUCT</b>				
▷	<div>= CRITICAL CHARACTERISTIC FLAG PER SPEC. XXXX</div>		SCALE	SIZE	SHEET		PART NUMBER: <b>4181-XPG-3ES</b>		
			NTS	B	1 OF 1				
			FILE:	DIRECTORY:		REV			
			4181-XPG-3ES		SLW		B		