

FOR Ø0.125  
RCA PLUG

0.31  
[7.9]  
Ø0.328  
[8.33]  
REF

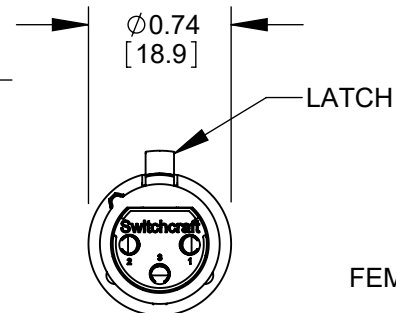
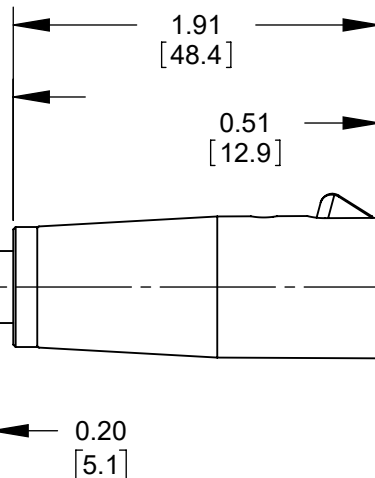

FEMALE 3 PIN XLR

ADAPTER  
HOUSING

RCA JACK  
ASSEMBLY

#### NOTES:

- MATERIALS:  
RCA JACK ASSEMBLY:  
HOUSING - COPPER ALLOY, TIN PLATED  
INSULATOR - THERMOPLASTIC  
RECEPTACLE - COPPER ALLOY, MATTE TIN

FEMALE XLR SUB-ASSEMBLY:  
SHELL - STAINLESS STEEL  
INSULATOR - THERMOPLASTIC, GREEN  
CONTACTS - SPECIAL COPPER ALLOY, SILVER PLATED  
CONTACT FINGER - SPECIAL COPPER ALLOY, BRIGHT NICKEL  
LATCH - ZINC ALLOY, NICKEL PLATED  
SCREW - STAINLESS STEEL

ADAPTER HOUSING - ZINC ALLOY, SATIN NICKEL  
TUBULAR INSULATOR - MYLAR

- SHIPPED WIRED AND ASSEMBLED.
- THIS PRODUCT IS RoHS COMPLIANT.

#### WIRING

RCA JACK	FEMALE XLR
CENTER PIN	PIN #2

**CUSTOMER DRAWING**

					<div>UNLESS OTHERWISE SPECIFIED</div> <div>1. ALL DIMENSIONS IN INCHES</div> <div>- TWO PLACE DECIMALS     ±0.02</div> <div>- THREE PLACE DECIMALS   ±0.005</div>	THIS DRAWING DESCRIBES A DESIGN CONSIDERED PROPRIETARY IN NATURE, DEVELOPED AND MANUFACTURED BY SWITCHCRAFT INC. AND IS RELEASED ON A CONFIDENTIAL BASIS FOR IDENTIFICATION PURPOSES ONLY.									
						SIZE	WIDTH		MULT		LBS/M		TEMPER		
						FINISH						MATERIAL			
						SPEC No.						SPEC No.			
						FIRST USED ON				SCALE		<div>Switchcraft®</div>			
								1:1							
A	27584	10-8-15	TO	TJK		DATE DRAWN	BY	CHKD	APVD		SHEET    1                      OF    1				
						10-21-15	TO	TO	TJK						
								10-21-15	10-21-15						
REV	ECO NUMBER	DATE	BY	APVD		NAME						PART No.		REV	
REVISIONS					DO NOT SCALE DRAWING	FEMALE 3 PIN XLR TO RCA JACK WIRED, RoHS						322WX		A	

SolidWorks CAD File

